



ENCLOSING ELECTRONICS ONE BOX AT A TIME

ENCLOSURES & ASSEMBLY SERVICES

ENCLOSURES & ASSEMBLY SERVICES

BOX ENCLOSURES, INC

28835 N. HERKY DRIVE, #114,
LAKE BLUFF, IL 60044

TEL: 847-932-4700

WWW.BOXENCLOSURES.COM

FAX: 847-932-4701

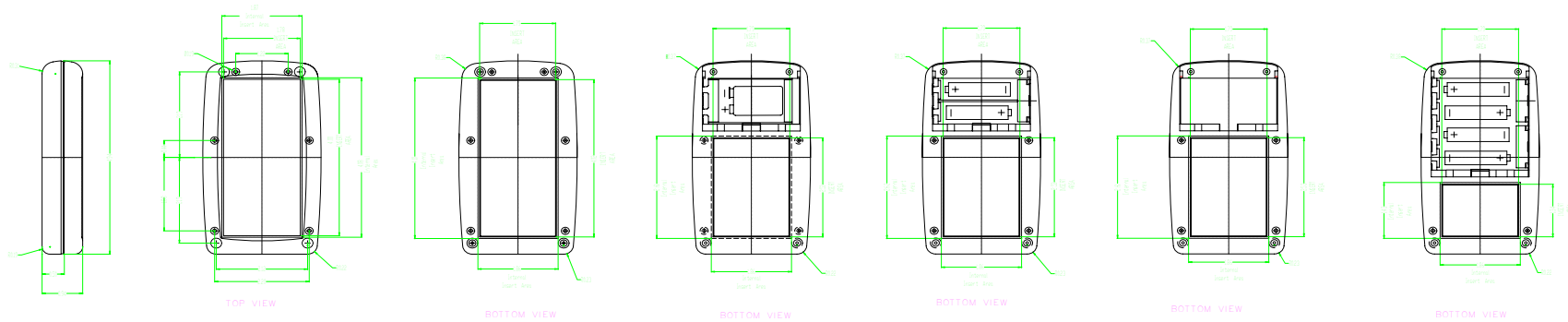

SIDE VIEW

TOP VIEW

BOTTOM VIEW

BOTTOM VIEW

BOTTOM VIEW

BOTTOM VIEW

BOTTOM VIEW

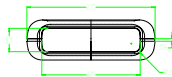

FRONT VIEW

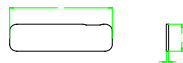

SMALL END PANEL



LARGE END PANEL

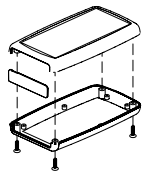

NO BATTERY COMPARTMENT

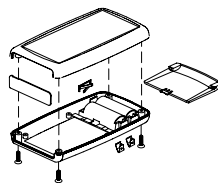

TWO AA

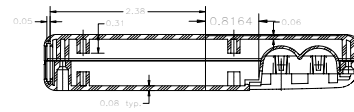

TWO AA

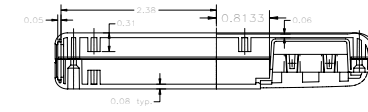

9V

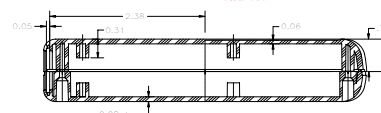

NO BATTERY COMPARTMENT W/ DEEP TOP

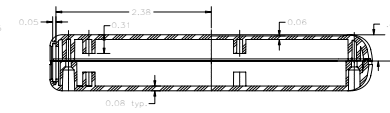

NO BATTERY COMPARTMENT W/ SHALLOW TOP

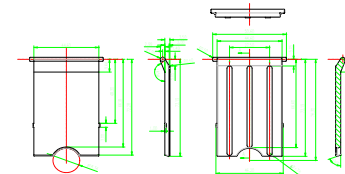
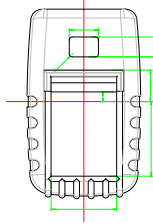
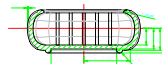
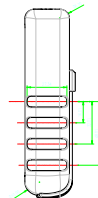
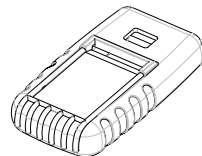
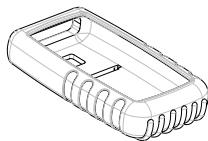
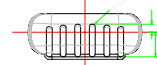
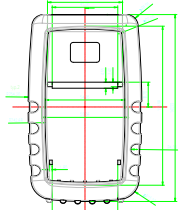
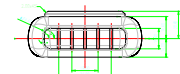

THIS DRAWING IS THE PROPERTY OF AND MAY EMBODY PROPRIETARY INFORMATION OWNED BY X-Box Enclosures. IT IS PROVIDED UNDER A CONFIDENTIAL RELATIONSHIP FOR A SPECIFIC PURPOSE. THE RECIPIENT AGREES TO USE IT ONLY FOR SUCH PURPOSE AND RETURN IT TO X-Box Enclosure UPON REQUEST.

<p>ENCLOSING ELECTRONICS ONE BOX AT A TIME</p> <p>ENCLOSURES & ASSEMBLY SERVICES</p>		Revision:	
Title: 55-SERIES		Model:	
Material:	TOLERANCE all dimension in mm unless otherwise specified	Dwg. No.:	Part No.:
Finish:	x ±0.20 .x ±0.10 .xx ±0.05 ANGLE ±0.5°	Color:	Dwn. Date Tan zonghaun Apr 10 04 Chk. Date
Proj.		A4 Sheet of	App. Date